

TO COOK (Soft/Medium/Hard)

1. Place the Base on a dry, level surface.
2. Fill the measuring cup to the line of desired doneness SOFT, MEDIUM or HARD and the amount of eggs being cooked 1-7.
3. Place the Cooking Rack on a flat counter surface.
4. Pierce the large end of each egg with the Piercing Pin at the bottom of the cup. This will prevent the egg shell from cracking while the eggs are cooking. CAUTION: The Piercing Pin is very sharp; use extreme care.
5. Place eggs pierced end up in the Cooking Rack. Place Cooking Rack on Base and cover with lid.
6. Plug the unit into a 120 volt electrical outlet. Turn the switch on "1". The Indicator Light will glow, indicating the eggs are cooking.
7. Once all the water has evaporated the unit will "buzz" signaling that the eggs are ready.
8. Turn switch off "0". Carefully unplug the unit.
9. With eggs still on the Cooking Rack, carefully remove the Cooking Rack and rinse briefly under cold water. CAUTION: After cooking cycle is complete, Egg Cooker and eggs will be very hot. Use caution when handling.
10. Serve eggs immediately.

TO POACH

1. Place the Base on a dry, level surface.
2. Fill the measuring cup to the line of POACH and the amount of eggs being cooked 1-4.
3. Lightly butter or oil the poaching sections to be used.
4. Place Cooking Rack on the base, place Poaching Tray on Cooking Rack making sure the bottom of the poaching tray is centered on the Cooking Rack. There are 4 locating tabs on the Cooking Rack that will engage the bottom of the poaching tray.
5. Break one egg into each section of the Poaching Tray. Then cover with Lid.
6. Plug the unit into a 120 volt electrical outlet. Turn the switch on "1". The Indicator Light will glow, indicating the eggs are cooking.
7. Once all the water has evaporated the unit will "buzz" signaling that the eggs are ready.
8. Turn switch off "0". Carefully unplug the unit.
9. When removing Poaching Tray, securely grasp Poaching Tray knob and carefully lift it off the Cooking Rack. CAUTION: After cooking cycle is complete, Egg Cooker and eggs will be very hot. Use caution when handling.
10. To avoid overcooking, serve eggs immediately.

KNOW YOUR EGG COOKER

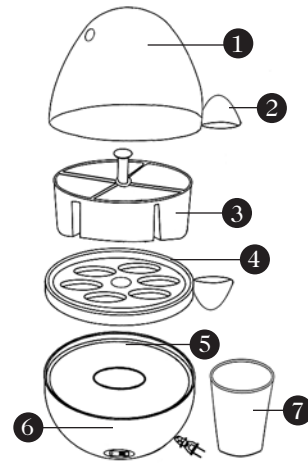

1. Lid
2. Cool Touch Handle
3. Poaching Tray
4. Cooking Rack
5. Heater Plate
6. Base
7. Measuring Cup

Do not send any parts or product to Maverick without calling and obtaining a Return Authorization Number and instructions.

This warranty is VOID if instructions for use are not followed; for accidental damage; for commercial use; for damage incurred while in transit; or if the egg cooker has been tampered with.

This warranty gives you specific legal rights and you may also have other rights which vary from state to state.

REPAIRS & SERVICING

CAUTION: There are no consumer serviceable parts inside the egg cooker. Do not attempt any repairs or servicing on your own. If repairs or servicing are required, contact Maverick Industries for instructions on how to pack and ship the egg cooker to Maverick's service center located as follows:

Maverick Customer Service
94 Mayfield Ave.
Edison NJ 08837
Telephone (732) 417-9666
Hours: weekdays 8:30 AM - 4:30 PM
www.maverickhousewares.com

90 DAY WARRANTY

Maverick Industries Inc. warrants the egg cooker to be free of defects in parts, materials and workmanship for a period of 90 days, from date of purchase.

Should any repairs or servicing under this warranty be required, contact Maverick Customer Service by mail or phone for instructions on how to pack and ship the egg cooker to Maverick's National Service Center located as follows:

Maverick Customer Service
94 Mayfield Ave.
Edison NJ 08837
Telephone (732) 417-9666
Hours: weekdays 8:30 AM - 4:30 PM
www.maverickhousewares.com



Egg Cooker



Model EC-200

IMPORTANT SAFEGUARDS

When using this and other electrical appliances, the basic safety precautions listed should always be followed:

1. Read all instructions before using the appliance.
2. Do not touch hot surfaces, use handles or knobs.
3. To protect against electrical shock, do not immerse any part of the appliance in water or other liquid.
4. Close supervision is necessary when any appliance is used by or near children.
5. Always unplug appliance from outlet when not in use and before cleaning. Allow to cool before putting on or taking off parts.
6. Do not operate any appliance with a damaged cord or plug, after appliance malfunctions, or is dropped or damaged in any manner. Contact Maverick Industries, Inc. Customer Service for instructions on how to return the appliance for examination, repair or electrical adjustment.
7. Do not use any unauthorized attachments that are not recommended or sold by Maverick Industries. This will void the warranty and may cause fire, electric shock or injury.
8. Do not use outdoors or in a damp area.
9. Do not let cord hang over edge of table or counter or touch hot surfaces.
10. Do not place appliance on or near a hot gas or electric burner or in a heated oven.
11. To disconnect, grasp plug and remove from outlet. Never unplug by pulling the cord.
12. CAUTION: This appliance generates heat and escaping steam during use. Proper precautions must be taken to prevent the risk of burns, fires or other damage to persons or property.
13. Do not leave this appliance unattended during use.
14. This appliance is for household use only. Do not use appliance for other than intended use.

SAVE THESE INSTRUCTIONS

POLARIZED PLUG

This appliance is equipped with a polarized plug (one blade is wider than the other). As a safety feature, this plug will fit in a polarized outlet only one way. If the plug does not fully fit into your outlet, reverse plug. If it still does not fit contact a qualified electrician. Do not attempt to defeat this safety feature. Never use with an extension cord unless the plug can be fully inserted.

SHORT CORD INSTRUCTIONS

A short power-supply cord is provided to reduce the risks resulting from becoming entangled in or tripping over a long extension cord.

Extension cords are available and may be used if care is exercised in their use.

The marked electrical rating of the extension cord should be at least as great as the electrical rating of the appliance.

The longer cord should be arranged so that it will not drape over the countertop or table top where it can be pulled on by children or tripped over.

CAUTION

Warning: To reduce the risk of fire or electrical shock, do not remove the base panel of the appliance. There are no user serviceable parts inside. Repair should be done by Maverick authorized personnel only. **For household use only.**

BEFORE FIRST USE

Before using the appliance for the first time, and after periods of prolonged storage, clean it thoroughly. Please refer to the Care & Cleaning section.

PRECAUTIONS

1. Prior to operating Egg Cooker, make sure all Egg Cooker parts are securely in place.
2. Avoid contact with steam while unit is “ON”.
3. During cooking cycle, all Egg Cooker parts become hot. Do not touch or move Base, Cooking Rack, Poaching Tray, or Lid while unit is “ON”.

HELPFUL HINTS

Egg cooking times are affected by factors such as:

1. Number and size of eggs cooked: More eggs cooked at one time INCREASES cooking time so LESS water is needed. Larger eggs require more water to cook.
2. Temperature of eggs prior to cooking: Cold eggs require longer cooking time than room temperature eggs.
3. Temperature and amount of water used: Cold water increases cooking time. More water used increases cooking time.
4. Altitude: The higher the elevation, the longer eggs will take to cook.
5. Length of time the eggs remain in Egg Cooker following cooking cycle: After the Egg Cooker “buzzes”, cooking continues until eggs are removed.

CARE and CLEANING

Wash Lid, Poaching Tray and Cooking Rack in hot soapy water or in a dishwasher (top rack only). Rinse thoroughly and dry. Let the Base cool and wipe it with a damp cloth or sponge. DO NOT IMMERSSE BASE IN WATER OR OTHER LIQUID. Place Cooking Rack and Poaching Tray inside Egg Cooker for storage.